

VISUAL ARRIVAL RWY 27R

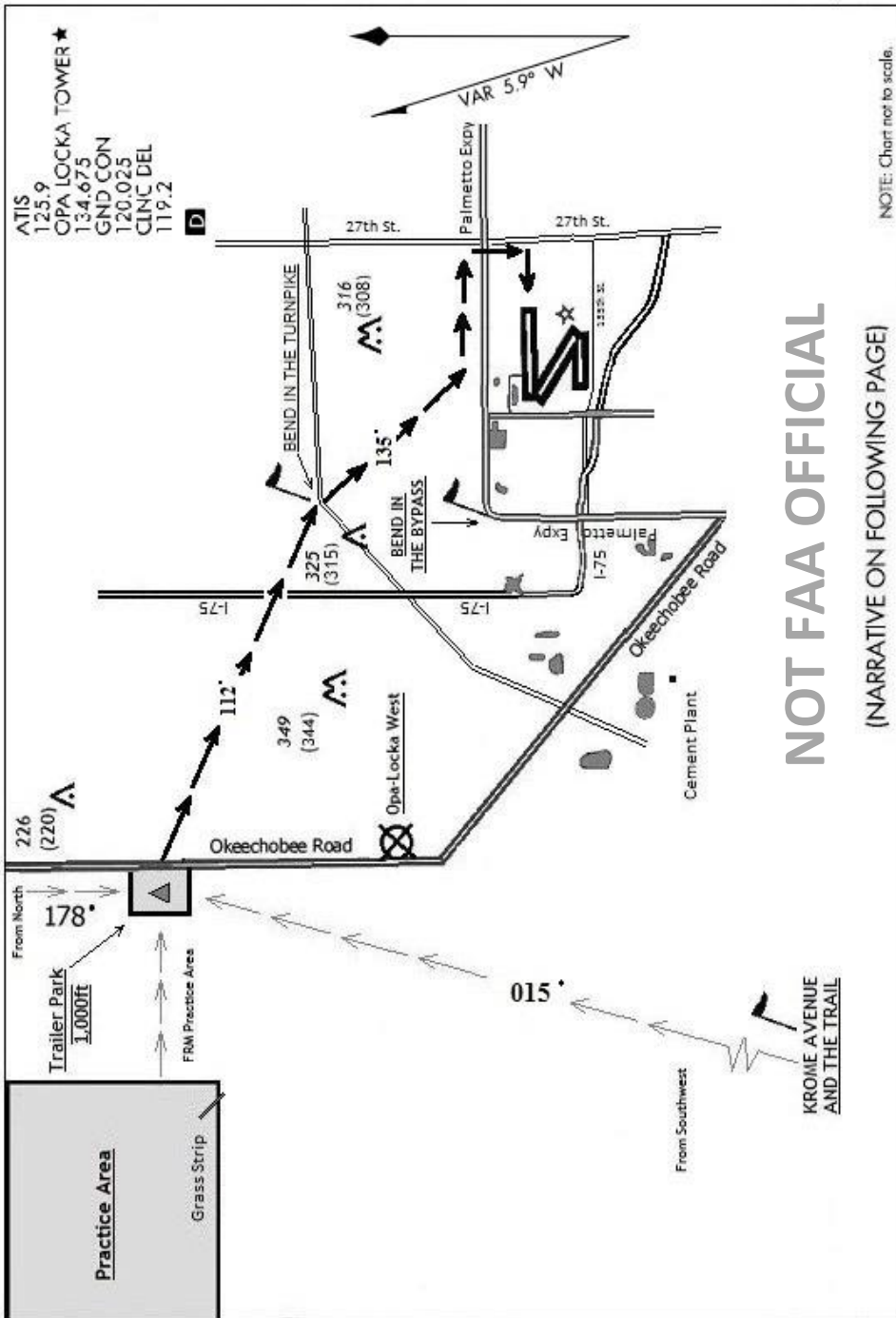

NOTE: Chart not to scale.

NOT FAA OFFICIAL
(NARRATIVE ON FOLLOWING PAGE)

ARRIVAL ROUTE DESCRIPTION

ARRIVAL RWY 27R

Over fly the trailer park at 1,000ft MSL and contact KOPF TWR (134.675) report position/altitude and intentions. Then proceed on a southeasterly heading of 112 deg. to the BEND IN THE TURNPIKE. Then proceed on a heading of 135 deg. to join runway 27R traffic pattern at mid field downwind (north of the Palmetto Expy) for a right traffic.

NOT FAA OFFICIAL

VISUAL DEPARTURE RWY 27R

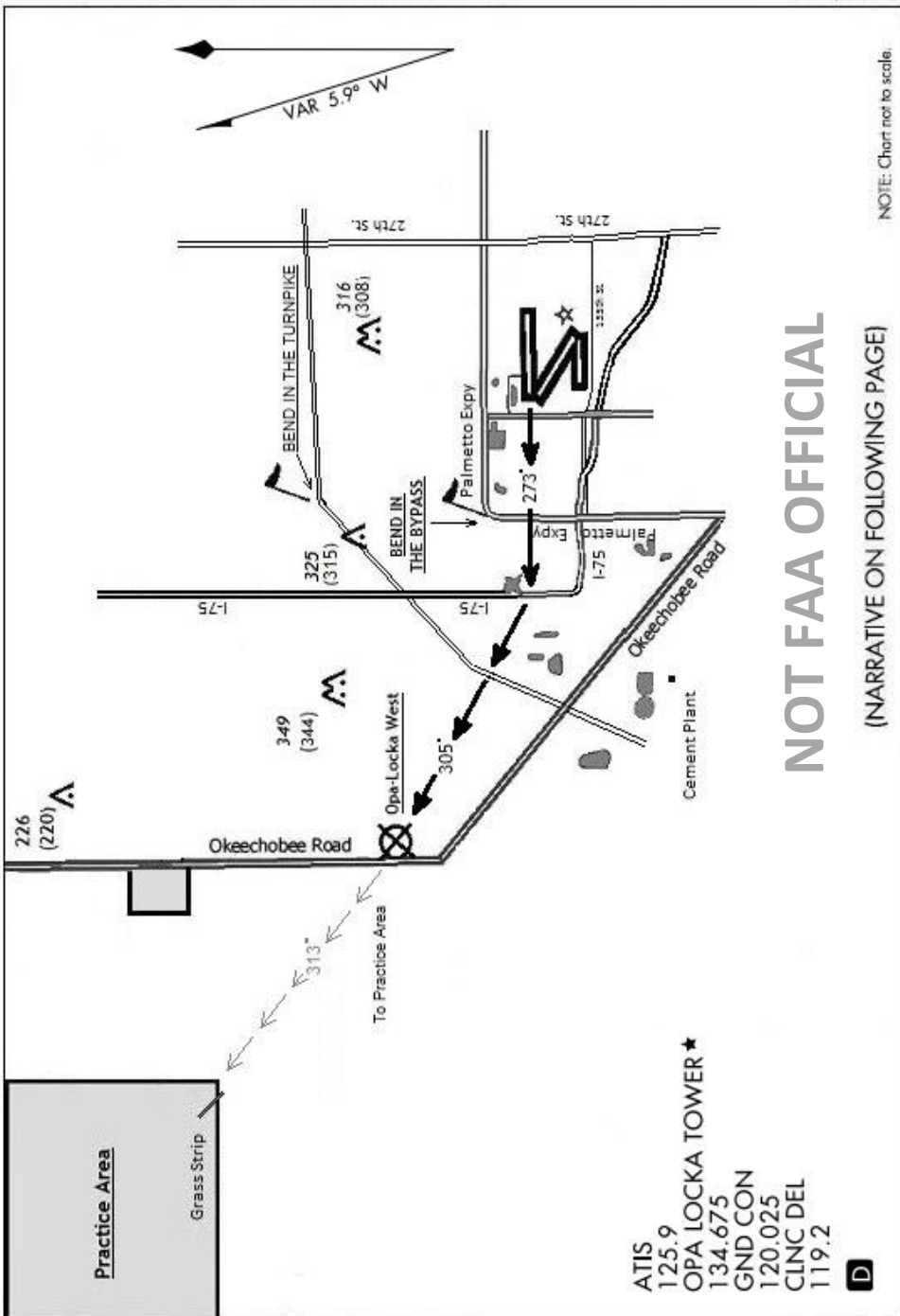

NOTE: Chart not to scale.

NOT FAA OFFICIAL
(NARRATIVE ON FOLLOWING PAGE)

ATIS 125.9
OPA LOCKA TOWER ★
134.675
GND CON 120.025
CLNC DEL 119.2
D

DEPARTURE ROUTE DESCRIPTION

VISUAL DEPARTURE RWY 27R

After takeoff climb to 1,000 ft MSL, continue on heading 273 until crossing I-75. Then proceed on heading 305 deg. towards OPA LOCKA WEST. When over OPA LOCKA WEST continue to the Practice Area on heading 313 deg. or as required by ATC.

NOT FAA OFFICIAL